

GENERAL NOTES:

1. TRENCH DEPTH SHALL BE 24" MIN. SHOULD CONDITIONS NOT ALLOW FOR 24" MIN DEPTH THE CONDUIT SHALL BE CONCRETE (CLASS "A") ENCASED IN ALL APPLICATIONS.
2. SCHEDULE 40 P.V.C. CONDUIT SHALL BE USED IN ALL APPLICATIONS AND SHALL USE "LONG SWEEP: RADIUS BENDS.
3. SAWCUT SIDEWALK AT EXISTING JOINTS AND REPLACE ENTIRE SECTION TO MATCH EXISTING MATERIAL. WHEN NEW SIDEWALK IS BEING CONSTRUCTED, CONDUIT, PULL BOXES AND POLES ARE TO BE INSTALLED PRIOR TO SIDEWALK POUR AND SHALL BE LEVELED TO FINAL GRADE.
4. TYPE 2 WARNING TAPE SHALL BE INSTALLED IN ALL TRENCHES AT 12" BELOW FINISH GRADE.
5. INSTALL #14 AWG TRACE WIRE & "JET LINE" PULL STRING.

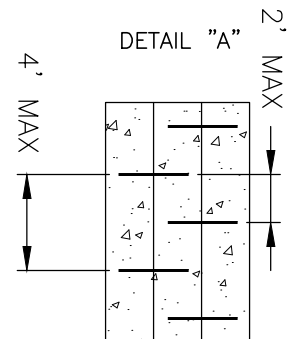

N.T.S

CITY OF FRANKLIN

CONDUIT TRENCH BACKFILL DETAIL

DWG. NO. ITS-3

EFFECTIVE DATE: 7/1/2017

Paul P. Hoff 7/1/2017
CITY ENGINEER DATE

Stephanie Martin 7/1/2017
ASST. DIRECTOR OF ENG. DATE